

Title  
**Marble River Wind Farm**  
 Towns of Clinton and Ellenburg,  
 Clinton County, New York

Location  
 Map

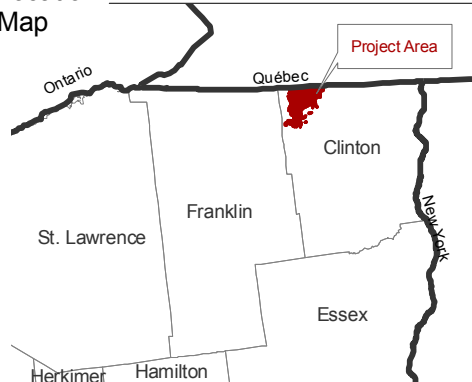

Notes

Map Created: July 2010.  
 Base Map: ESRI StreetMap North America 2008.  
 © 2010 Environmental Design & Research. Landscape  
 Architecture, Planning, Environmental Services,  
 Engineering and Surveying, P.C.

Author



Exhibit 4M: Turbine Setbacks

Index

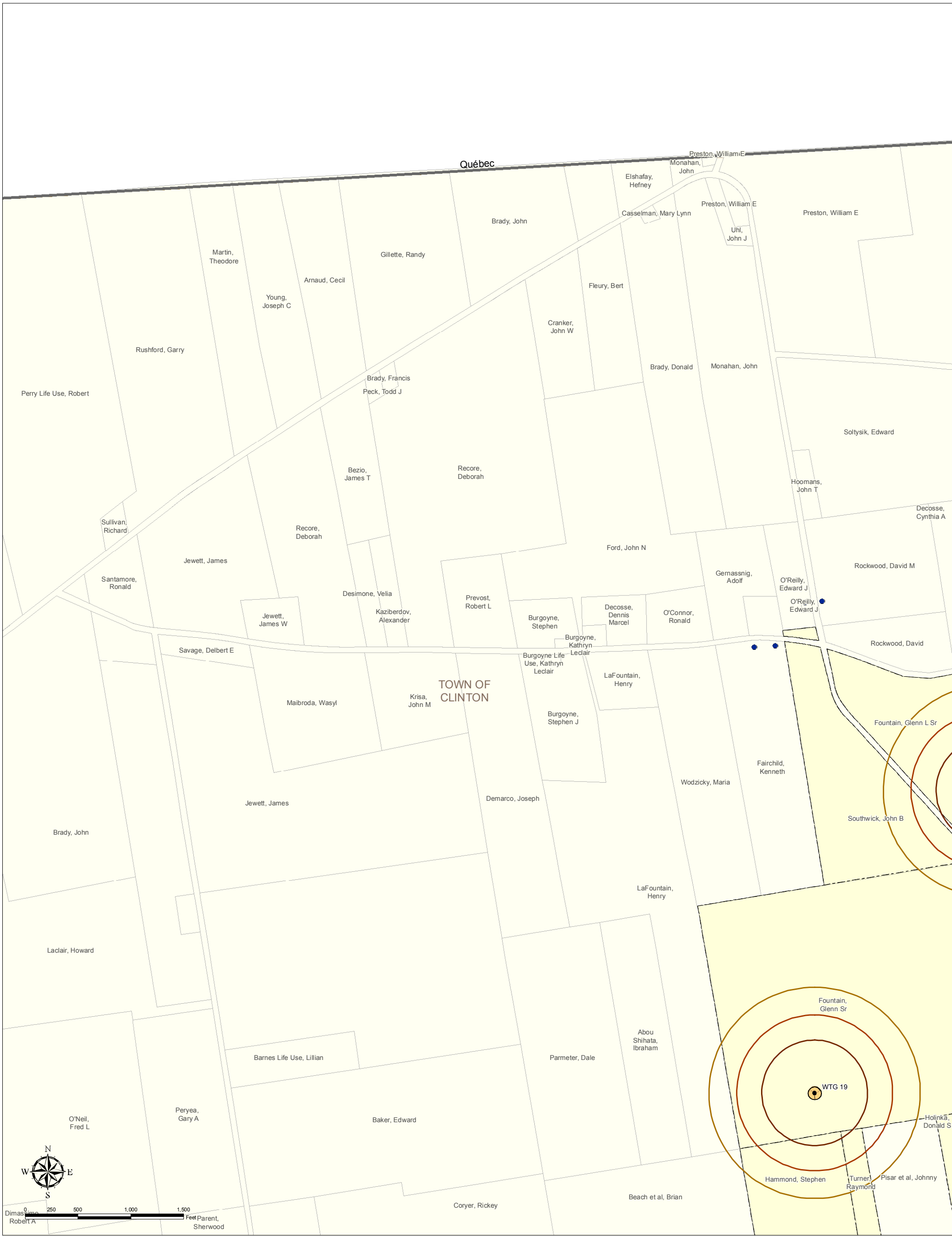

**Title**  
**Marble River Wind Farm**  
*Towns of Clinton and Ellenburg,  
 Clinton County, New York*

- Legend**
- Wind Turbine
  - Residence
  - 500ft Setback
  - 738ft Setback
  - 1000ft Setback
  - Participating Parcels

**Notes**

Map Created: July 2010.

Note: There are no houses within 500 feet of a turbine.

Base Map: 2010 Clinton County parcel data for Clinton and Ellenburg Towns.

© 2010 Environmental Design & Research. Landscape Architecture, Planning, Environmental Services, Engineering and Surveying, P.C.

**Author**

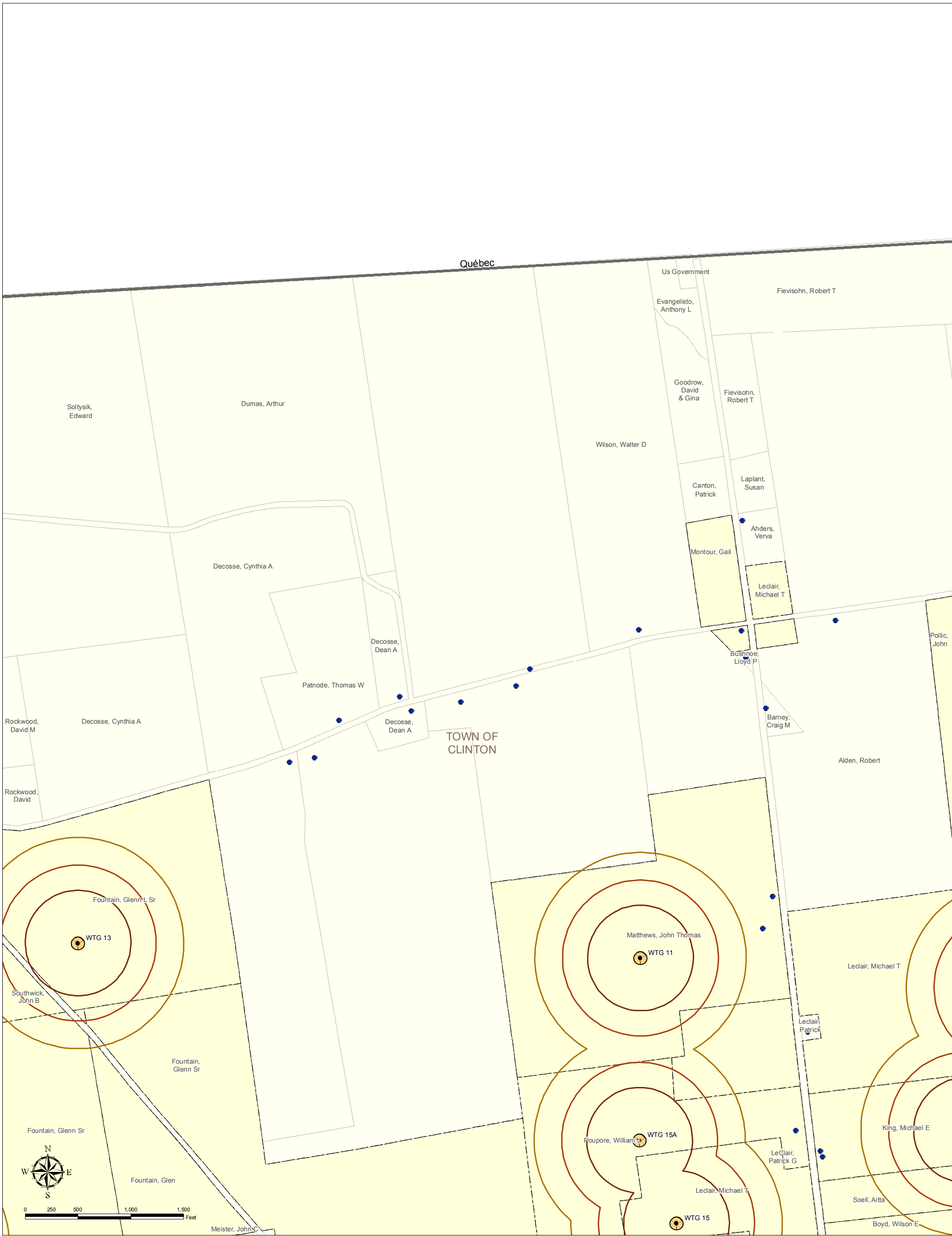

**Title**  
**Marble River Wind Farm**  
*Towns of Clinton and Ellenburg,  
 Clinton County, New York*

- Legend**
- Wind Turbine
  - Residence
  - 500ft Setback
  - 738ft Setback
  - 1000ft Setback
  - Participating Parcels

**Notes**

Map Created: July 2010.

Note: There are no houses within 500 feet of a turbine.

Base Map: 2010 Clinton County parcel data for Clinton and Ellenburg Towns.

© 2010 Environmental Design & Research. Landscape Architecture, Planning, Environmental Services, Engineering and Surveying, P.C.

**Author**

MARBLE RIVER WIND FARM™  
 Horizon Wind Energy  
 An EDP Renewables Company  
 EDR

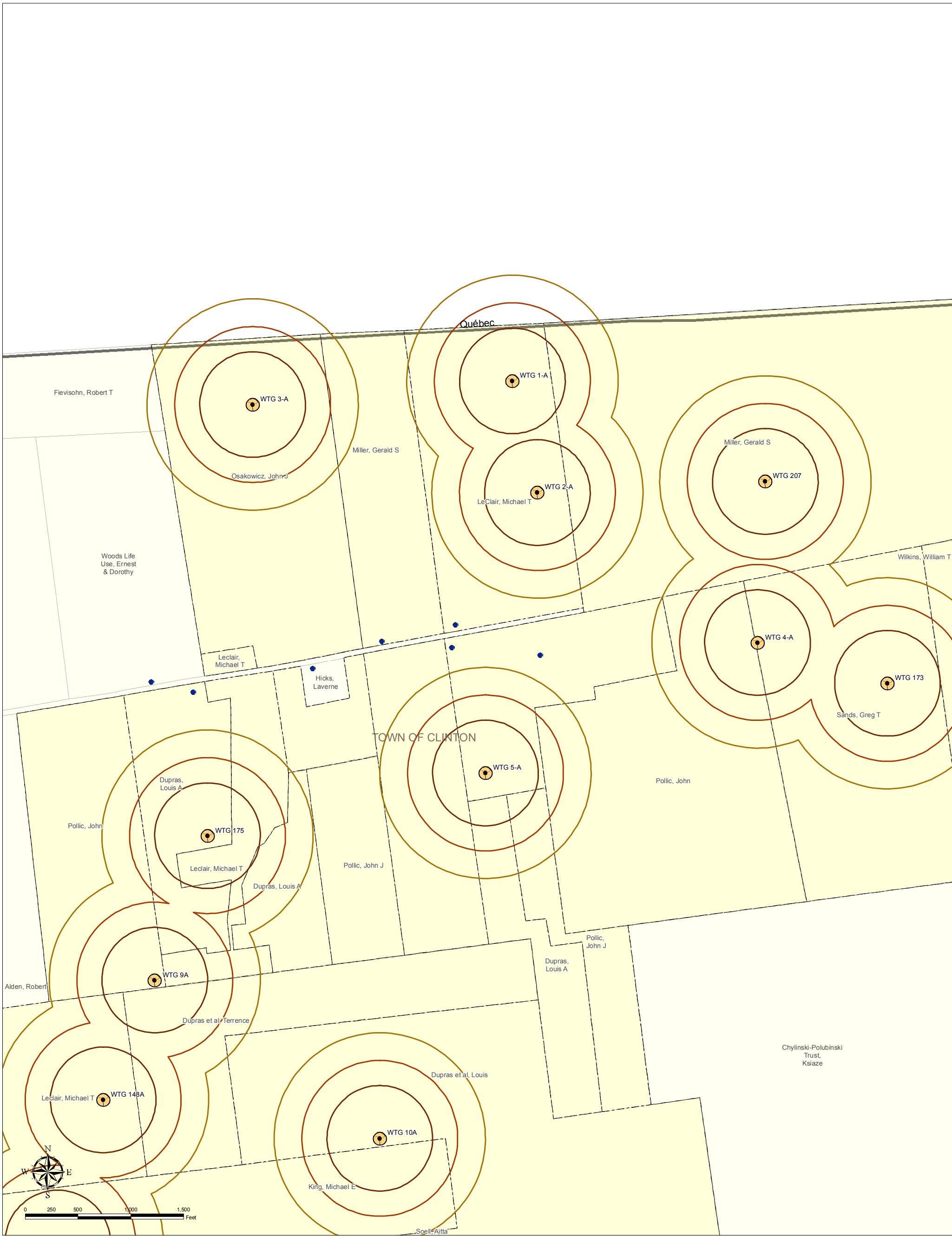

**Title**  
**Marble River Wind Farm**  
 Towns of Clinton and Ellenburg,  
 Clinton County, New York

- Legend**
- Wind Turbine
  - Residence
  - 500ft Setback
  - 738ft Setback
  - 1000ft Setback
  - Participating Parcels

**Notes**

Map Created: July 2010.

Note: There are no houses within 500 feet of a turbine.





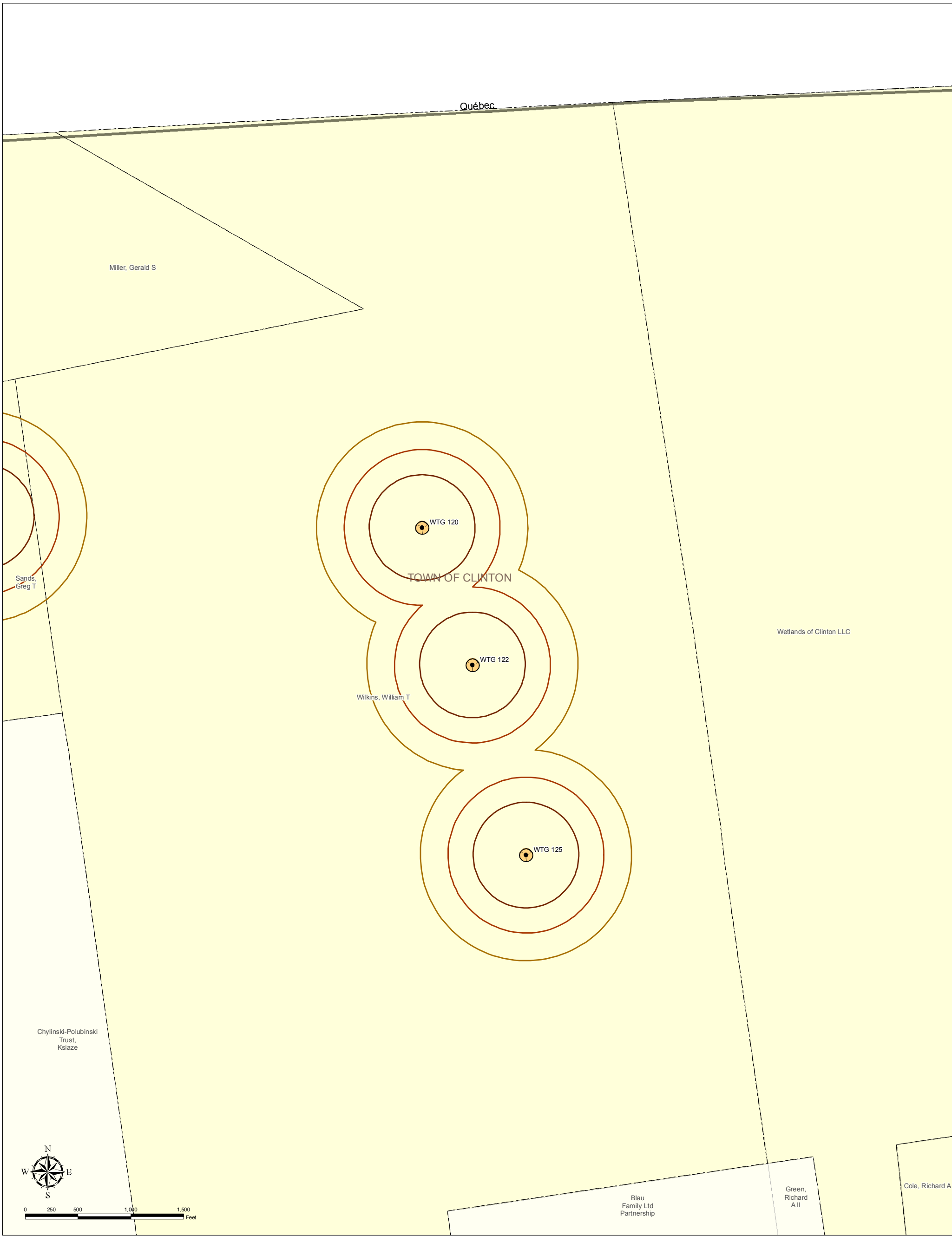

Base Map: 2010 Clinton County parcel data for Clinton and Ellenburg Towns.

© 2010 Environmental Design & Research. Landscape Architecture, Planning, Environmental Services, Engineering and Surveying, P.C.

**Author**

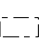

**Title**  
**Marble River Wind Farm**  
*Towns of Clinton and Ellenburg,  
 Clinton County, New York*

- Legend**
-  Wind Turbine
  -  Residence
  -  500ft Setback
  -  738ft Setback
  -  1000ft Setback
  -  Participating Parcels

**Notes**



Map Created: July 2010.

Note: There are no houses within 500 feet of a turbine.

Base Map: 2010 Clinton County parcel data for Clinton and Ellenburg Towns.

© 2010 Environmental Design & Research. Landscape Architecture, Planning, Environmental Services, Engineering and Surveying, P.C.

**Author**

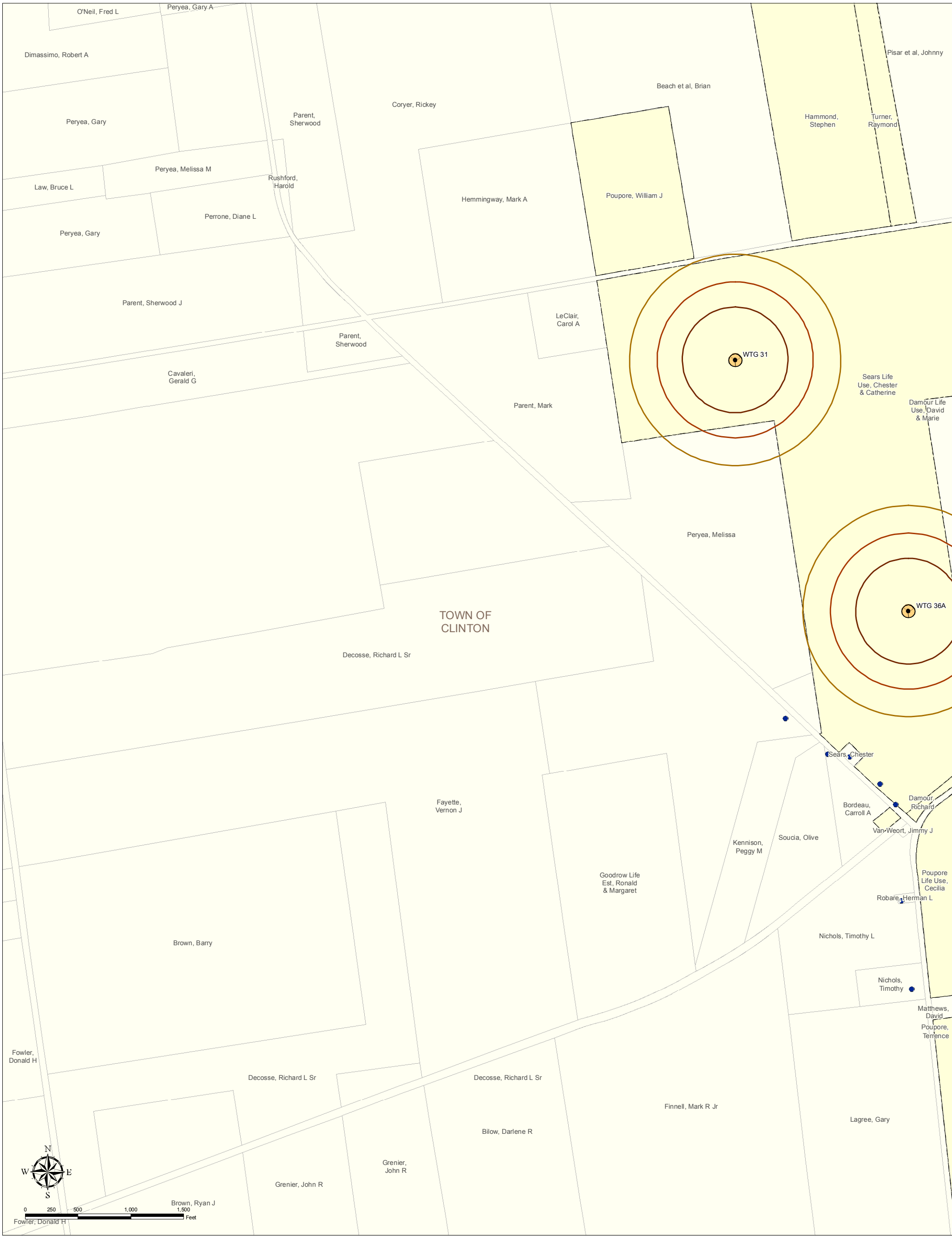

**Title**  
**Marble River Wind Farm**  
*Towns of Clinton and Ellenburg,  
 Clinton County, New York*

- Legend**
- Wind Turbine
  - Residence
  - 500ft Setback
  - 738ft Setback
  - 1000ft Setback
  - Participating Parcels

**Notes**

Map Created: July 2010.

Note: There are no houses within 500 feet of a turbine.

Base Map: 2010 Clinton County parcel data for Clinton and Ellenburg Towns.

© 2010 Environmental Design & Research. Landscape Architecture, Planning, Environmental Services, Engineering and Surveying, P.C.

**Author**



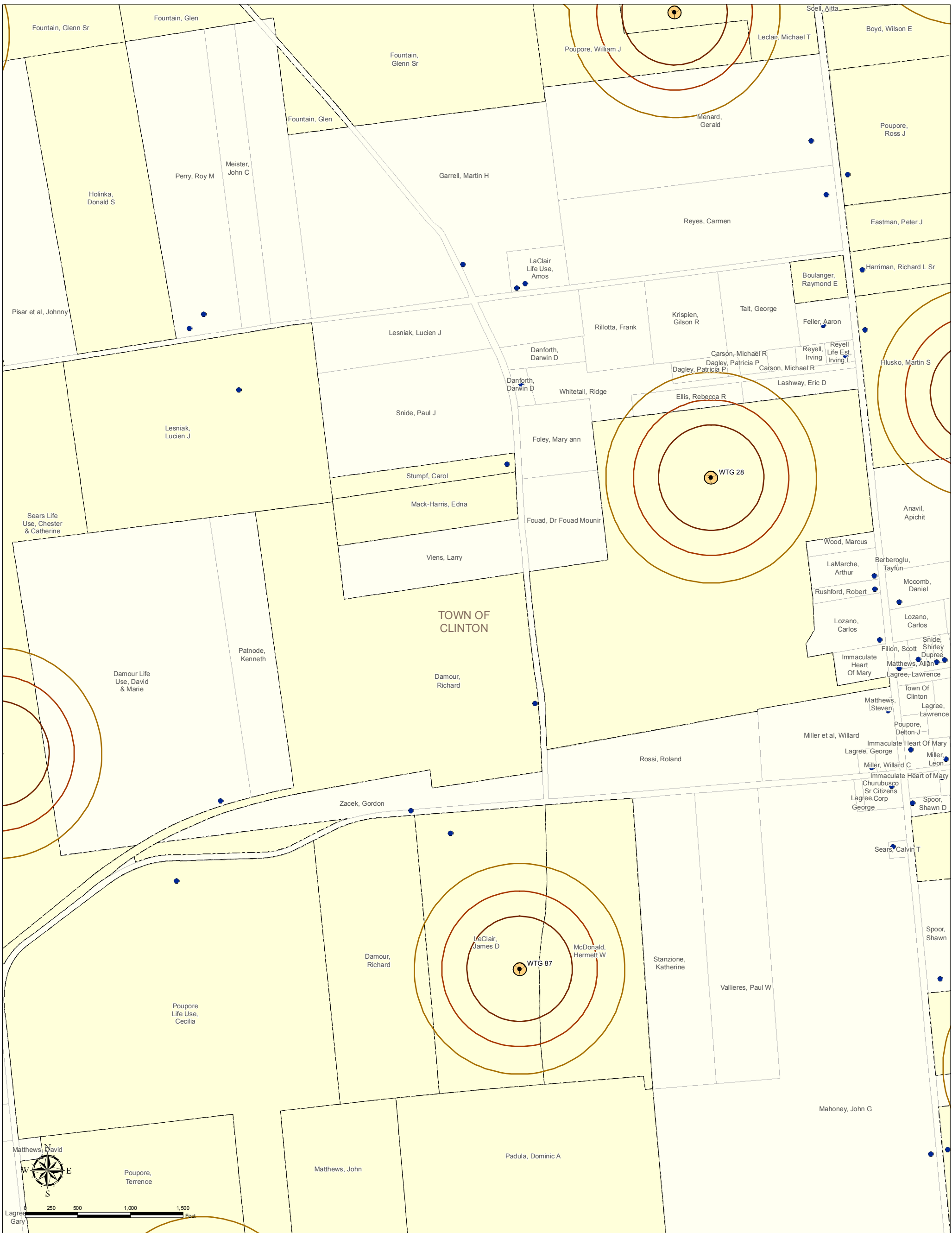

**Title**  
**Marble River Wind Farm**  
*Towns of Clinton and Ellenburg,  
 Clinton County, New York*

- Legend**
- Wind Turbine
  - Residence
  - 500ft Setback
  - 738ft Setback
  - 1000ft Setback
  - Participating Parcels

**Notes**

Map Created: July 2010.

Note: There are no houses within 500 feet of a turbine.

Base Map: 2010 Clinton County parcel data for Clinton and Ellenburg Towns.

© 2010 Environmental Design & Research. Landscape Architecture, Planning, Environmental Services, Engineering and Surveying, P.C.

**Author**

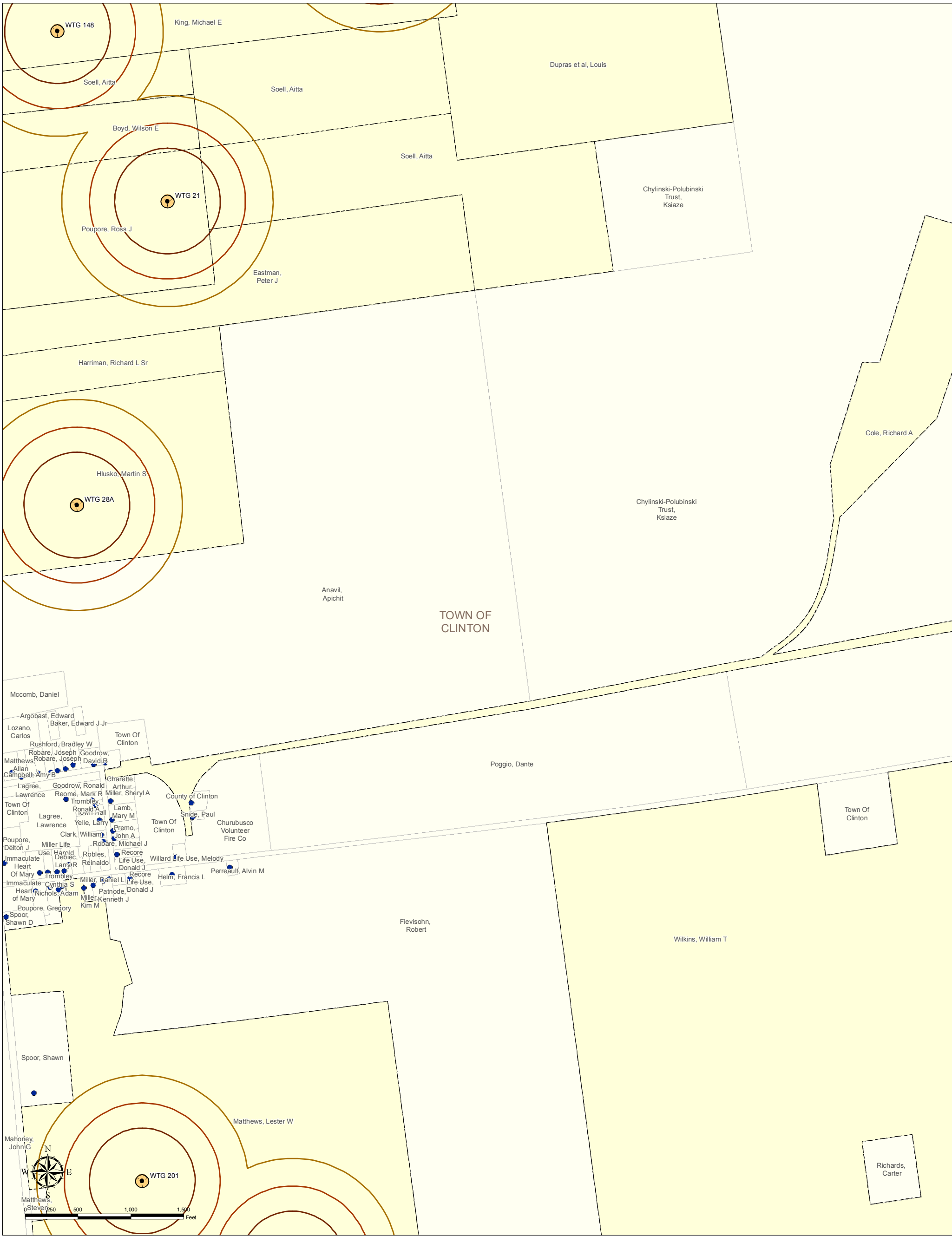

**Title**  
**Marble River Wind Farm**  
*Towns of Clinton and Ellenburg,  
 Clinton County, New York*

**Exhibit 4M: Turbine Setbacks**

Sheet 7 of 16

- Legend**
- Wind Turbine
  - Residence
  - 500ft Setback
  - 738ft Setback
  - 1000ft Setback
  - Participating Parcels

**Notes**



Map Created: July 2010.

Note: There are no houses within 500 feet of a turbine.

Base Map: 2010 Clinton County parcel data for Clinton and Ellenburg Towns.

© 2010 Environmental Design & Research. Landscape Architecture, Planning, Environmental Services, Engineering and Surveying, P.C.

**Author**



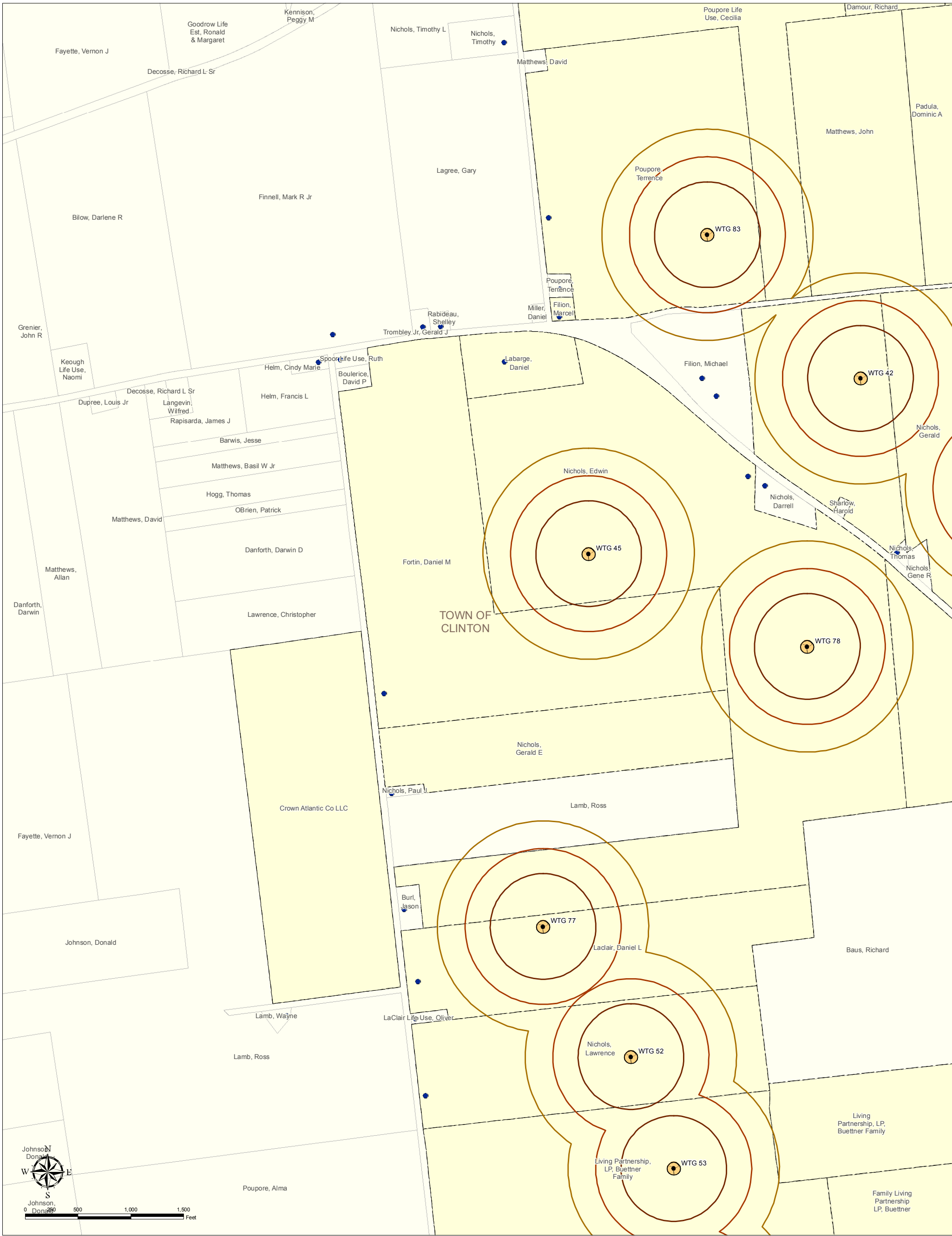

**Title**  
**Marble River Wind Farm**  
*Towns of Clinton and Ellenburg,  
 Clinton County, New York*

- Legend**
- Wind Turbine
  - Residence
  - 500ft Setback
  - 738ft Setback
  - 1000ft Setback
  - Participating Parcels

**Notes**

Map Created: July 2010.

Note: There are no houses within 500 feet of a turbine.

Base Map: 2010 Clinton County parcel data for Clinton and Ellenburg Towns.

© 2010 Environmental Design & Research. Landscape Architecture, Planning, Environmental Services, Engineering and Surveying, P.C.

**Author**

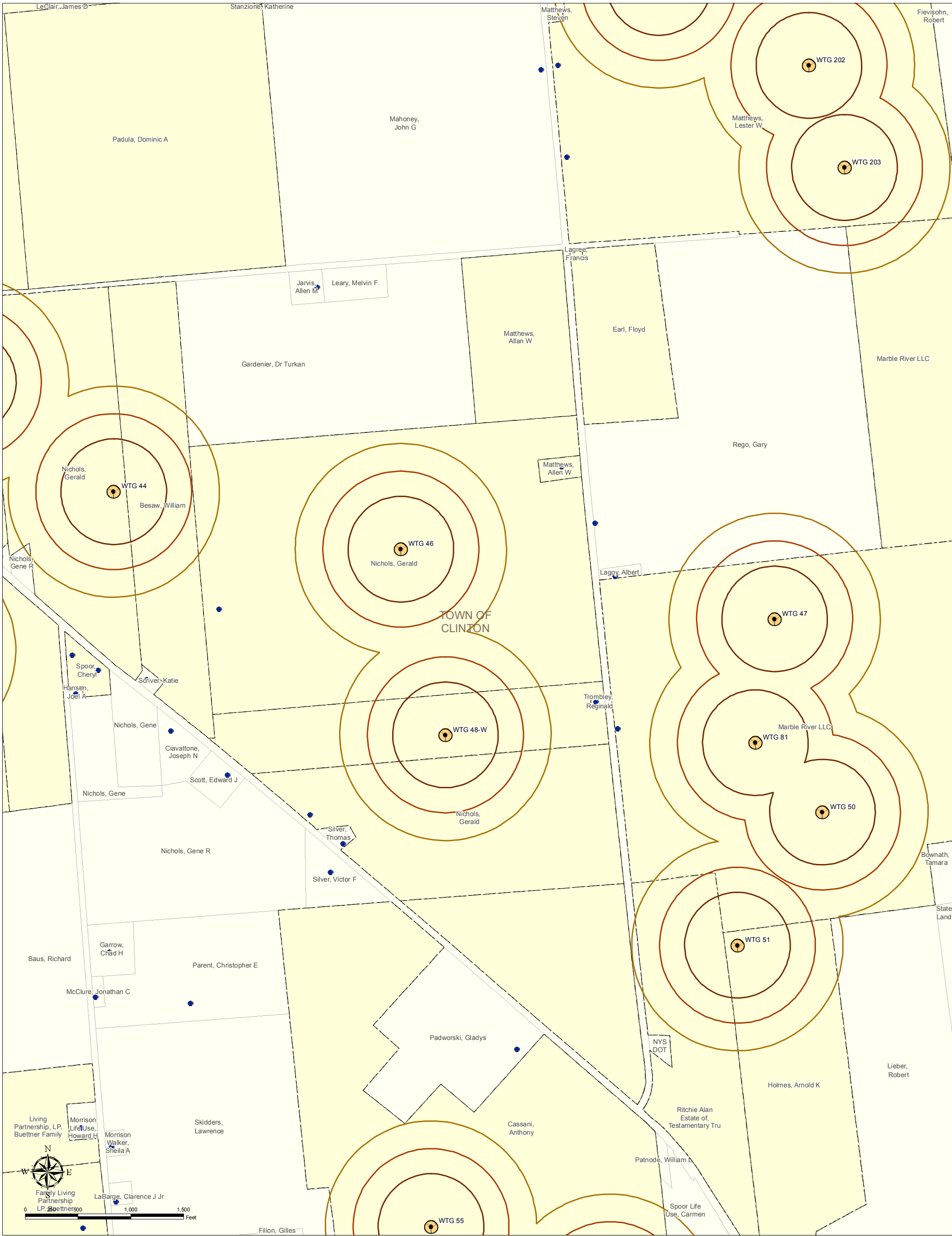

**Title**  
**Marble River Wind Farm**  
 Towns of Clinton and Ellenburg,  
 Clinton County, New York

- Legend**
- Wind Turbine
  - Residence
  - 500ft Setback
  - 738ft Setback
  - 1000ft Setback
  - Participating Parcels

**Notes**

Map Created: July 2010.

Note: There are no houses within 500 feet of a turbine.

Base Map: 2010 Clinton County parcel data for Clinton and Ellenburg Towns.





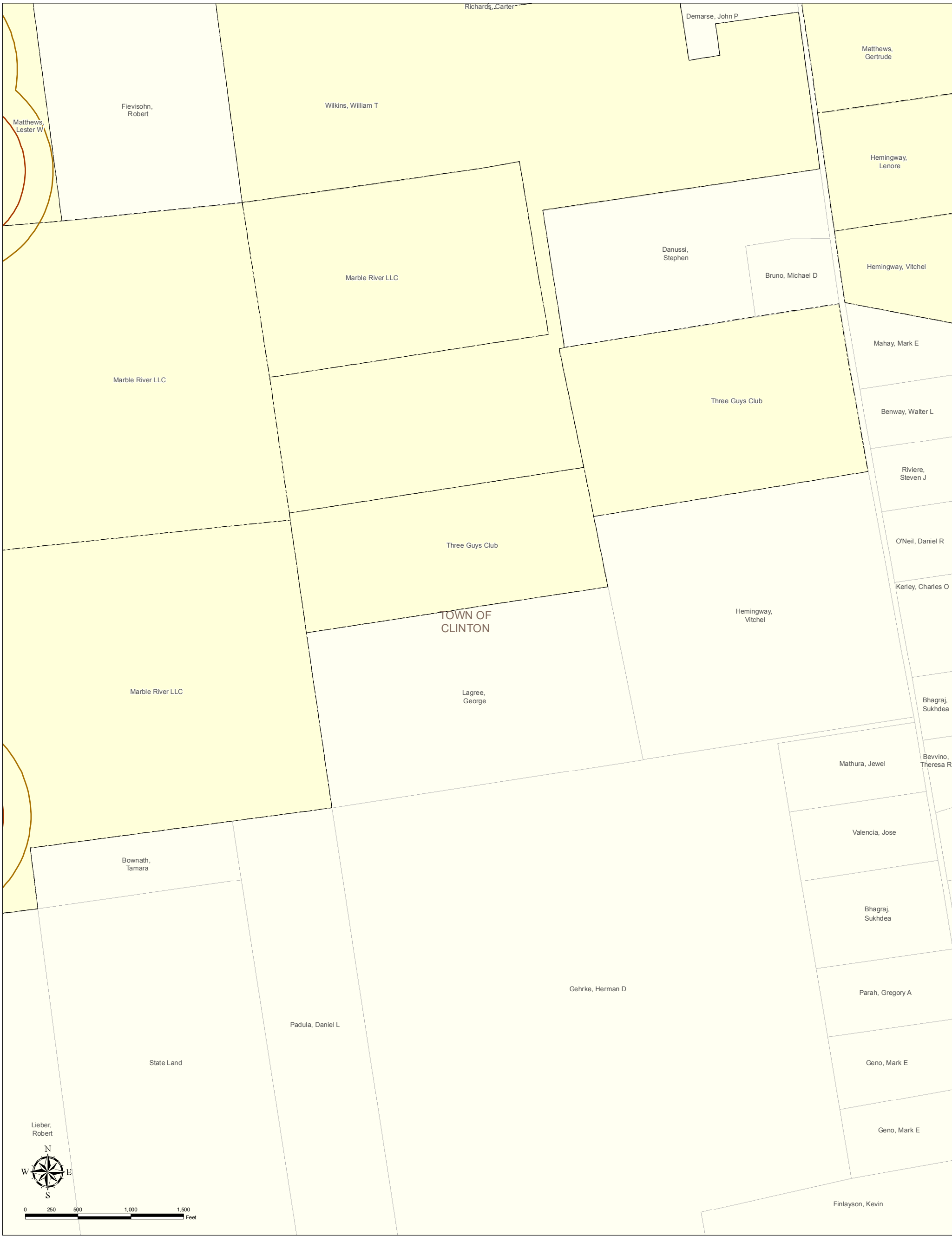

© 2010 Environmental Design & Research. Landscape Architecture, Planning, Environmental Services, Engineering and Surveying, P.C.

**Author**

MARBLE RIVER WIND FARM™  
 Horizon Wind Energy  
 An EDR Renewables Company  
 EDR

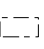

**Title**  
**Marble River Wind Farm**  
*Towns of Clinton and Ellenburg,  
 Clinton County, New York*

- Legend**
-  Wind Turbine
  -  Residence
  -  500ft Setback
  -  738ft Setback
  -  1000ft Setback
  -  Participating Parcels

**Notes**

Map Created: July 2010.

Note: There are no houses within 500 feet of a turbine.

Base Map: 2010 Clinton County parcel data for Clinton and Ellenburg Towns.

© 2010 Environmental Design & Research. Landscape Architecture, Planning, Environmental Services, Engineering and Surveying, P.C.

**Author**





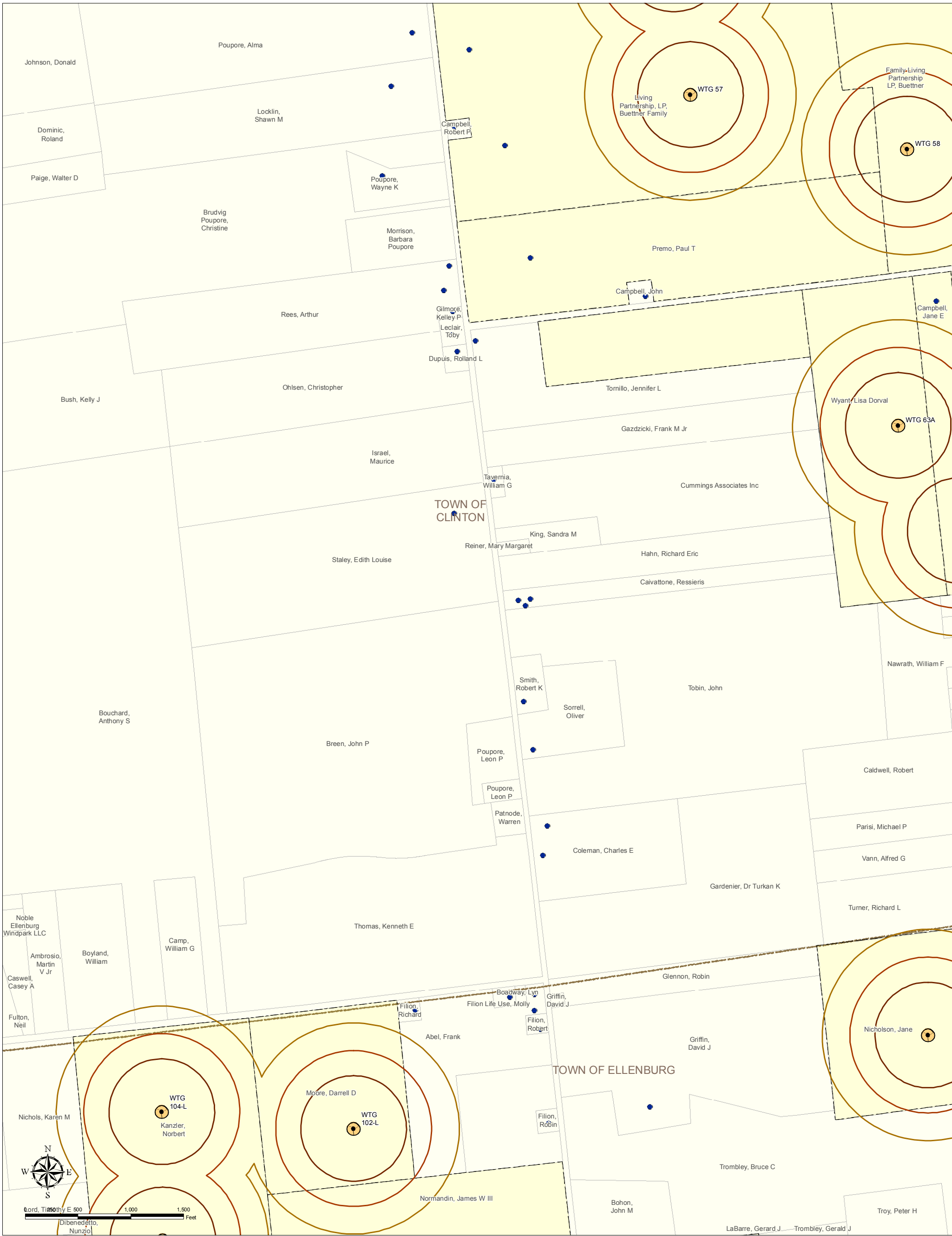

**Title**  
**Marble River Wind Farm**  
*Towns of Clinton and Ellenburg,  
 Clinton County, New York*

- Legend**
- Wind Turbine
  - Residence
  - 500ft Setback
  - 738ft Setback
  - 1000ft Setback
  - Participating Parcels

**Notes**

Map Created: July 2010.

Note: There are no houses within 500 feet of a turbine.

Base Map: 2010 Clinton County parcel data for Clinton and Ellenburg Towns.

© 2010 Environmental Design & Research. Landscape Architecture, Planning, Environmental Services, Engineering and Surveying, P.C.

**Author**

MARBLE RIVER WIND FARM™  
 Horizon Wind Energy  
 An EDP Renewables Company  
 EDR



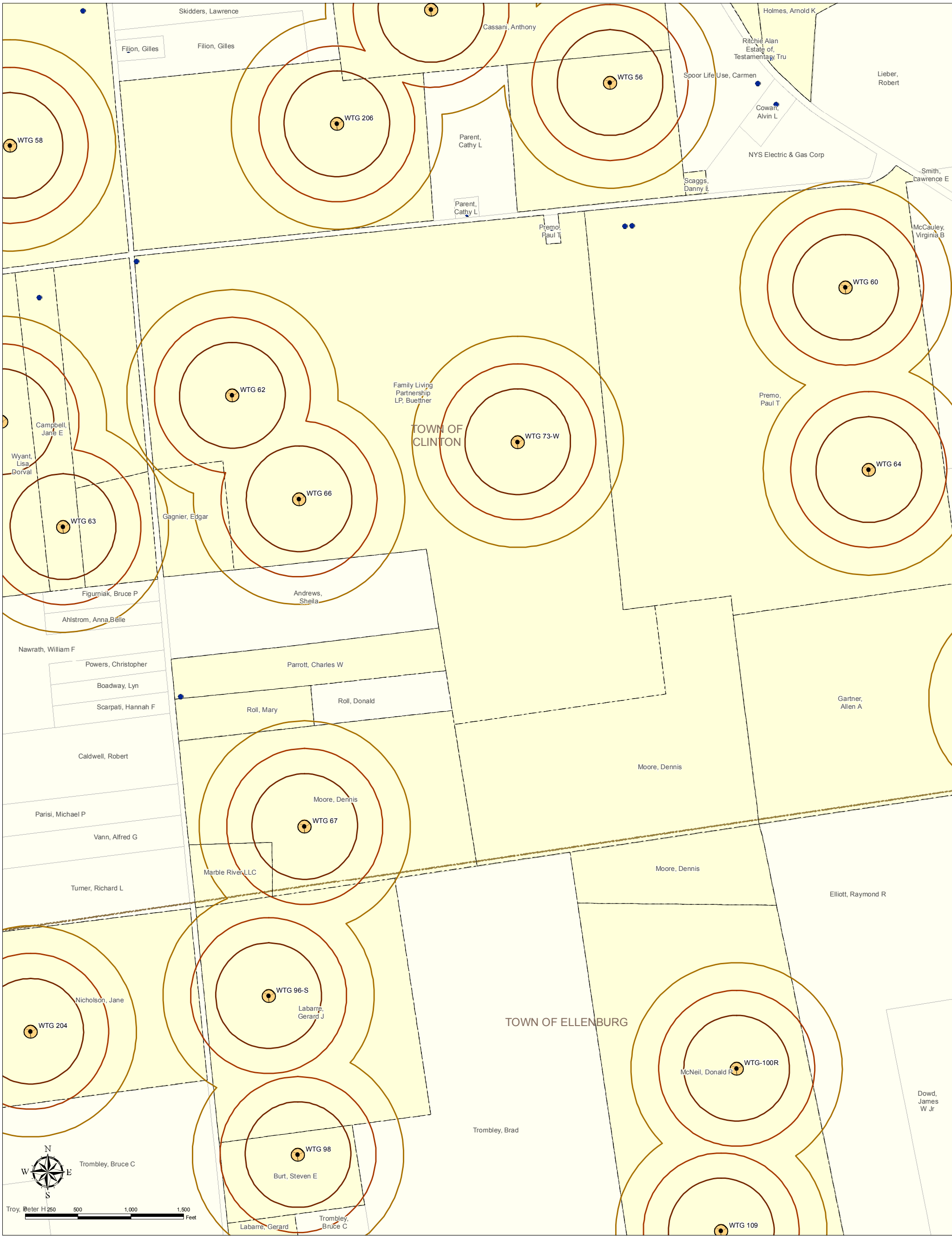

**Title**  
**Marble River Wind Farm**  
 Towns of Clinton and Ellenburg,  
 Clinton County, New York

- Legend**
- Wind Turbine
  - Residence
  - 500ft Setback
  - 738ft Setback
  - 1000ft Setback
  - Participating Parcels

**Notes**

Map Created: July 2010.

Note: There are no houses within 500 feet of a turbine.

Base Map: 2010 Clinton County parcel data for Clinton and Ellenburg Towns.

© 2010 Environmental Design & Research. Landscape Architecture, Planning, Environmental Services, Engineering and Surveying, P.C.

**Author**

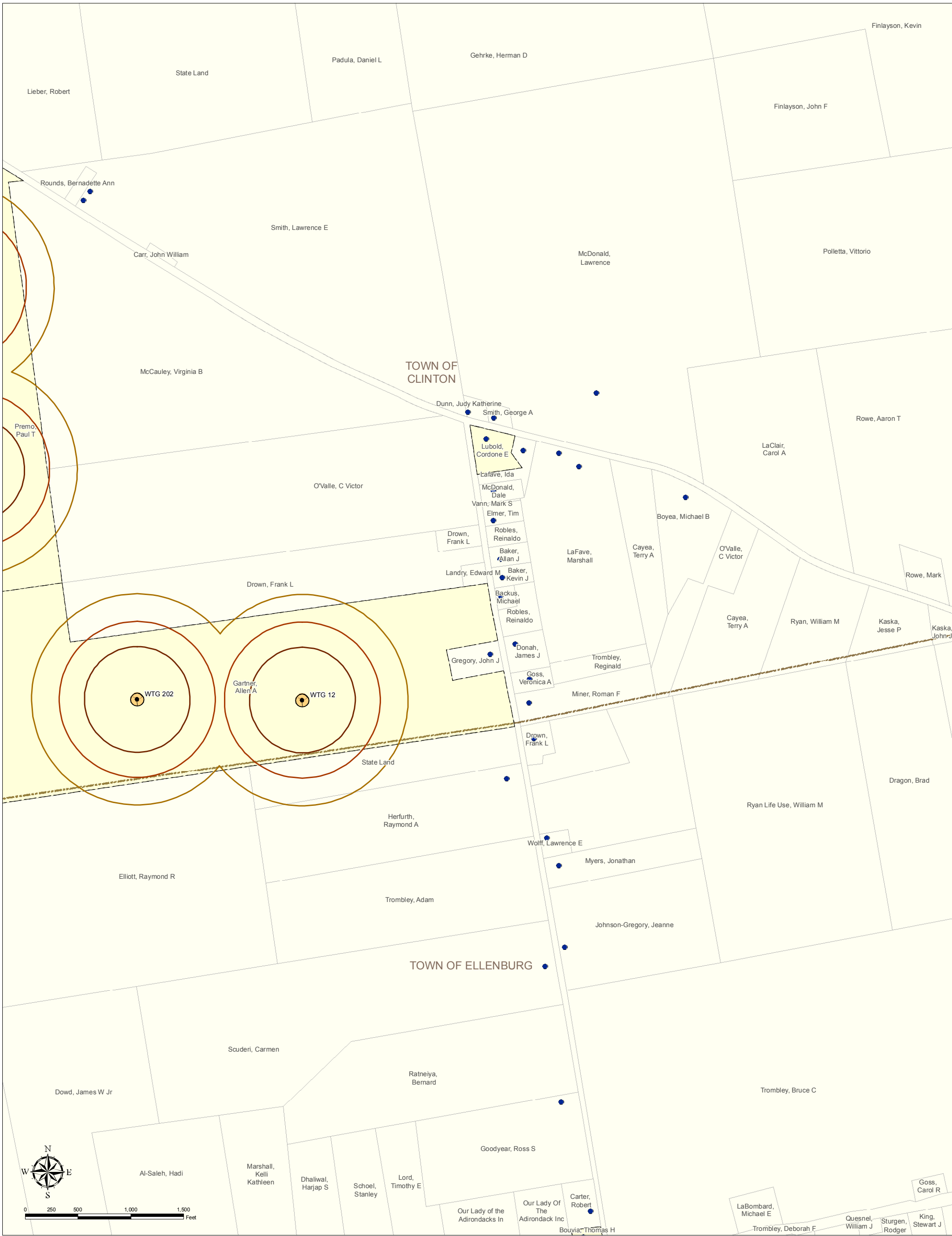

**Title**  
**Marble River Wind Farm**  
 Towns of Clinton and Ellenburg,  
 Clinton County, New York

- Legend**
- Wind Turbine
  - Residence
  - 500ft Setback
  - 738ft Setback
  - 1000ft Setback
  - Participating Parcels

**Notes**

Map Created: July 2010.

Note: There are no houses within 500 feet of a turbine.

Base Map: 2010 Clinton County parcel data for Clinton and Ellenburg Towns.

© 2010 Environmental Design & Research. Landscape Architecture, Planning, Environmental Services, Engineering and Surveying, P.C.

**Author**



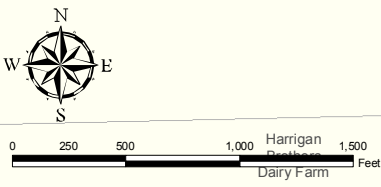
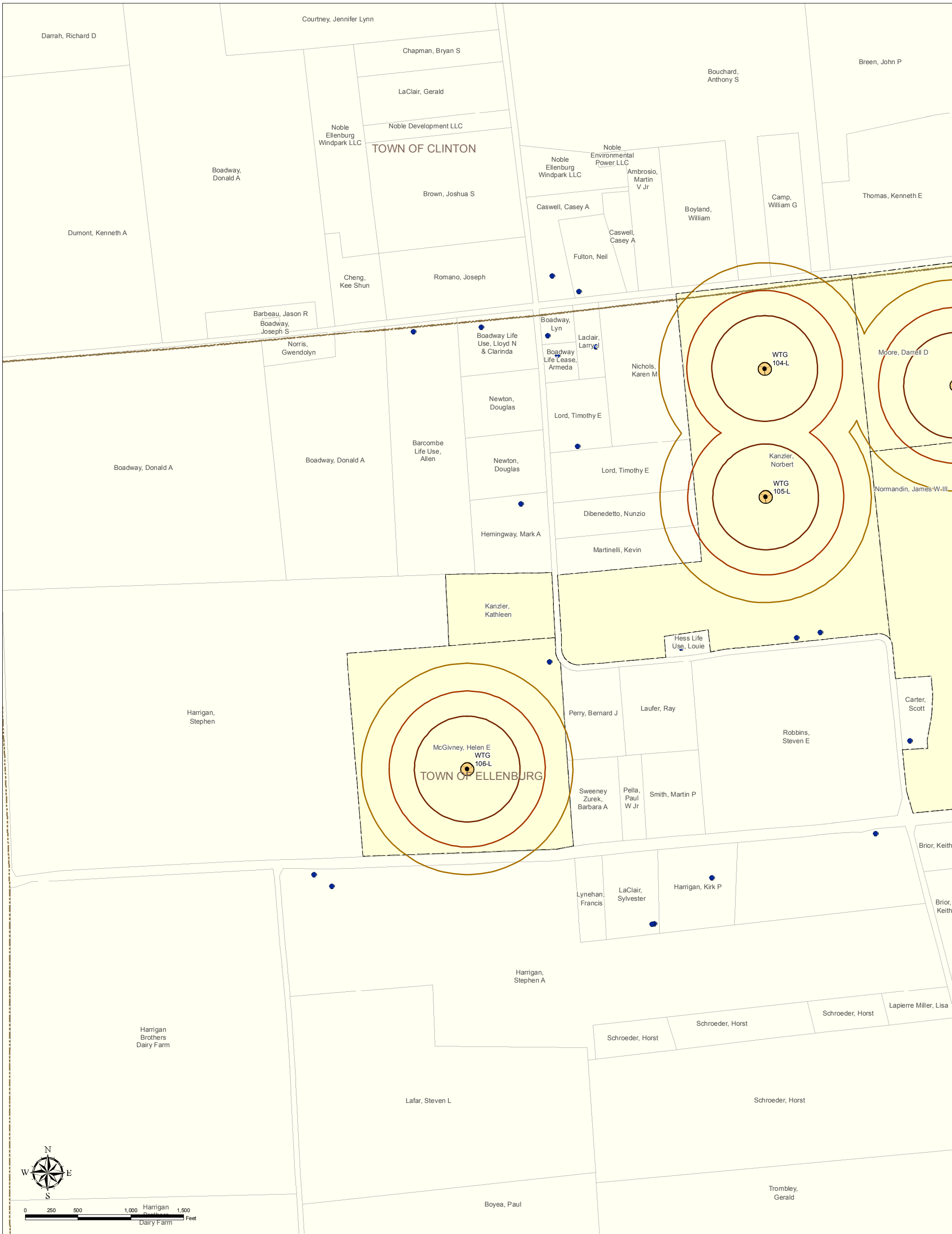

**Title**  
**Marble River Wind Farm**  
*Towns of Clinton and Ellenburg,  
 Clinton County, New York*

- Legend**
- Wind Turbine
  - Residence
  - 500ft Setback
  - 738ft Setback
  - 1000ft Setback
  - Participating Parcels

**Notes**

Map Created: July 2010.

Note: There are no houses within 500 feet of a turbine.

Base Map: 2010 Clinton County parcel data for Clinton and Ellenburg Towns.

© 2010 Environmental Design & Research. Landscape Architecture, Planning, Environmental Services, Engineering and Surveying, P.C.

**Author**

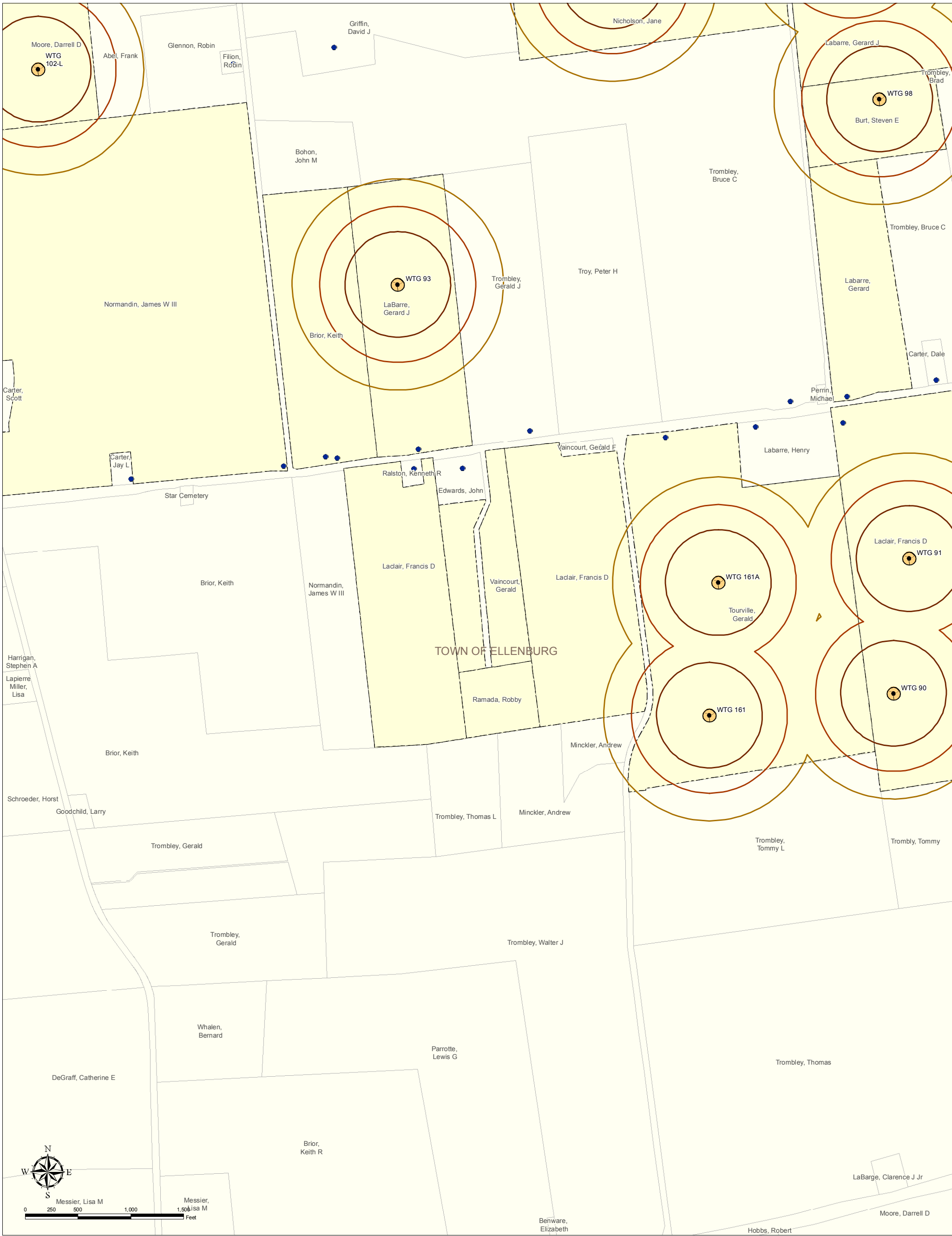

**Title**  
**Marble River Wind Farm**  
*Towns of Clinton and Ellenburg,  
 Clinton County, New York*

**Exhibit 4M: Turbine Setbacks**

Sheet 15 of 16

- Legend**
- Wind Turbine
  - Residence
  - 500ft Setback
  - 738ft Setback
  - 1000ft Setback
  - Participating Parcels

**Notes**

Map Created: July 2010.

Note: There are no houses within 500 feet of a turbine.

Base Map: 2010 Clinton County parcel data for Clinton and Ellenburg Towns.

© 2010 Environmental Design & Research. Landscape Architecture, Planning, Environmental Services, Engineering and Surveying, P.C.

**Author**

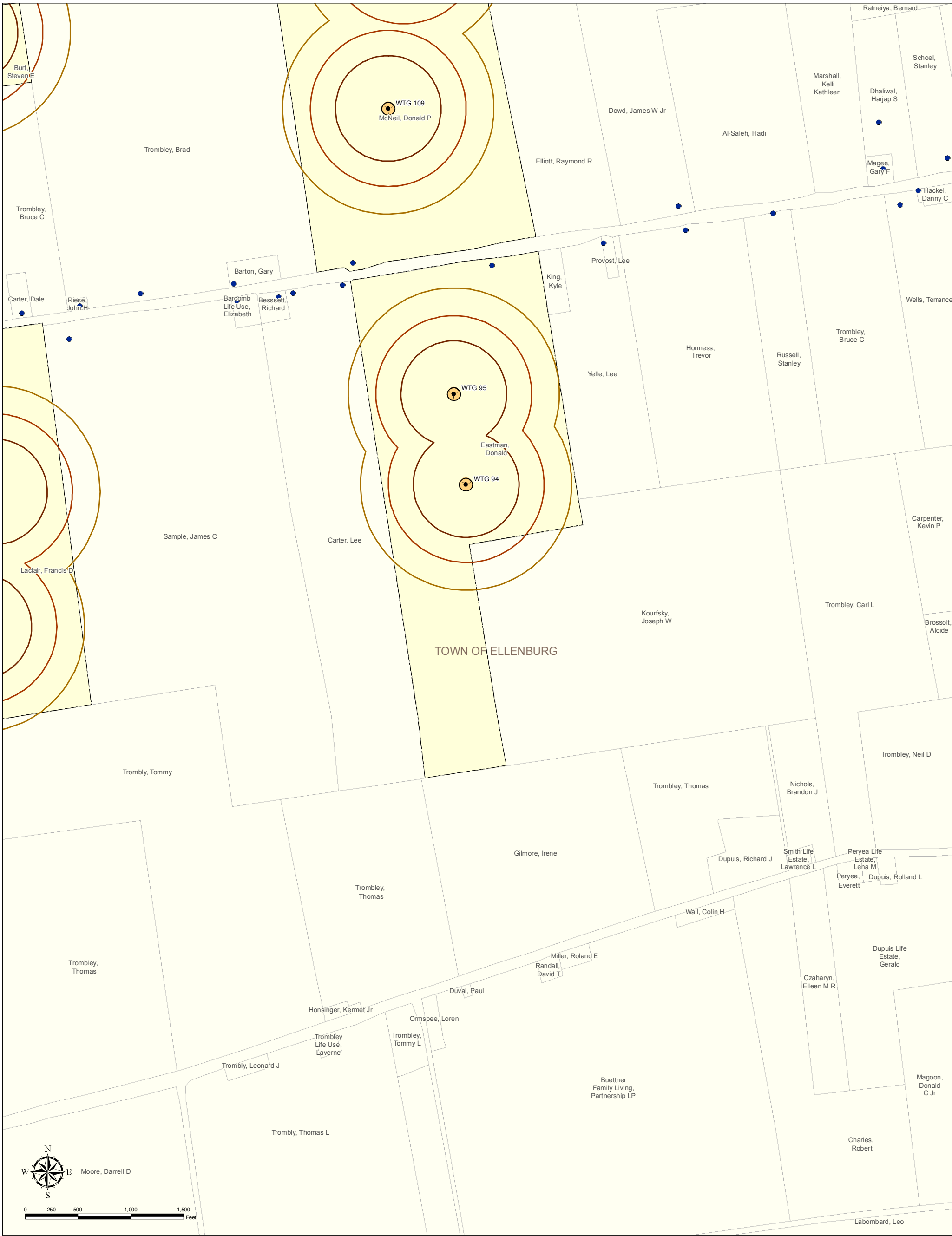

**Title**  
**Marble River Wind Farm**  
*Towns of Clinton and Ellenburg,  
 Clinton County, New York*

- Legend**
- Wind Turbine
  - Residence
  - 500ft Setback
  - 738ft Setback
  - 1000ft Setback
  - Participating Parcels

**Notes**

Map Created: July 2010.

Note: There are no houses within 500 feet of a turbine.

Base Map: 2010 Clinton County parcel data for Clinton and Ellenburg Towns.

© 2010 Environmental Design & Research. Landscape Architecture, Planning, Environmental Services, Engineering and Surveying, P.C.

**Author**